

KEY:		INDICATIVE SITE BOUNDARY
		PROPOSED KERB LINE
		PROPOSED FOOTWAY/CYCLEWAY
		PROPOSED ROAD MARKINGS
		PROPOSED OVERRUNNING AREA
GENERAL NOTES:		

P02	Roundabout updated	08/01/19	DD
Rev:	Description:	Date:	By:



 Merchant Exchange, 17-19 Whitworth Street West, Manchester, M1 5WG
 0161 236 2394
 manchester@curtins.com
 www.curtins.com

Civils & Structures • Transport Planning • Environmental • Infrastructure • Geotechnical • Conservation & Heritage • Principal Designer
 Birmingham • Bristol • Cambridge • Cardiff • Douglas • Dublin • Edinburgh • Glasgow • Kendal • Leeds • Liverpool • London • Manchester • Nottingham

Project:		WARRINGTON INTERCHANGE	
Drg Title:		POTENTIAL WESTERN ACCESS ROUNDABOUT	
Project No:	Originator:	Zone:	Level:
64076 - CUR - 00 - XX - DR - TP -			

Status:		PRELIMINARY	
Drawn By:	DD	Checked By:	LK
Designed By:	DD	Date:	06/07/18
Scale: AS INDICATED			
Discipline:		Category / Number:	
75002		-P02	

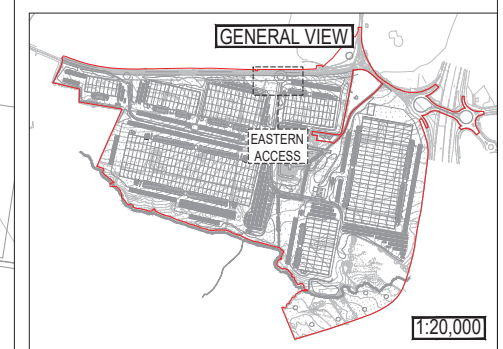
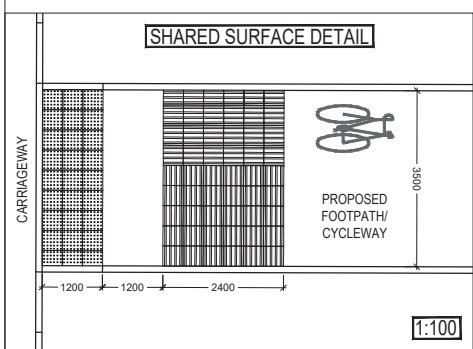
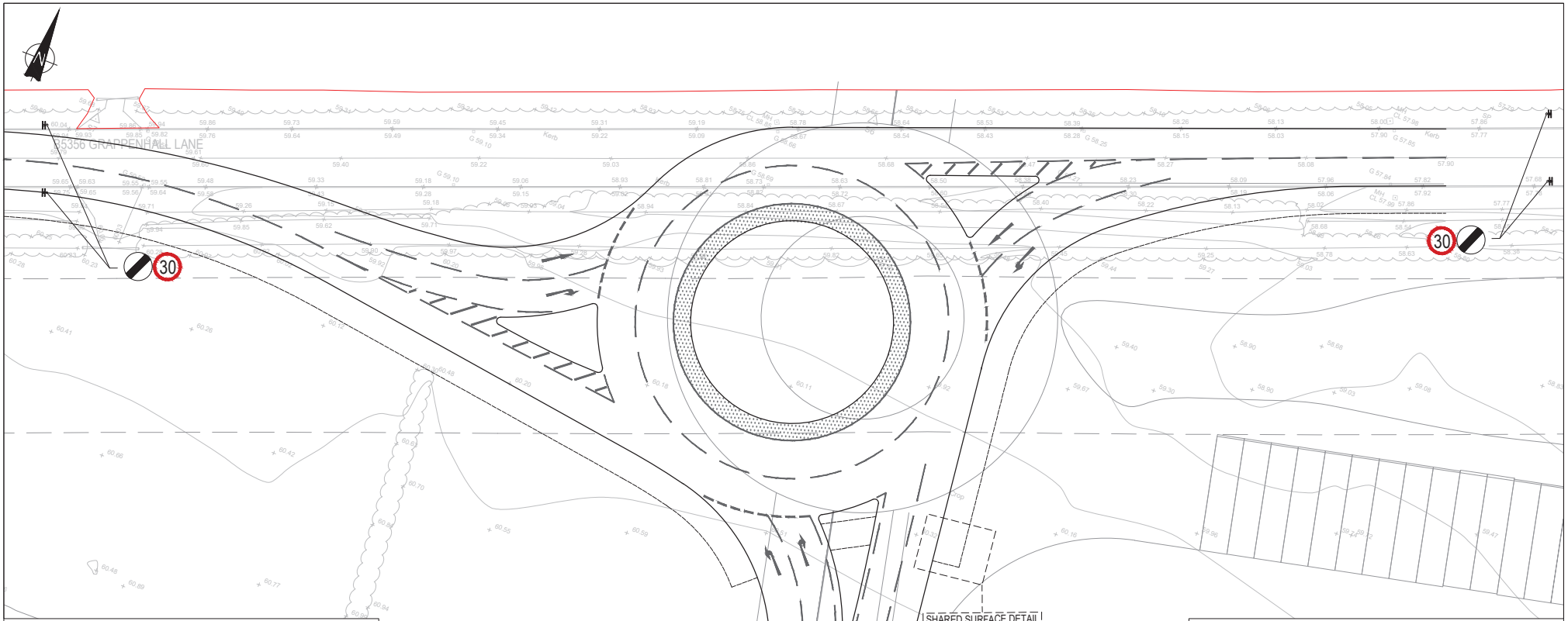
\mats62\Projects\064001 - 065000\064076 - Warrington Interchange TPMAE - Drawings\2-DWG\G15



KEY:

- INDICATIVE SITE BOUNDARY
- PROPOSED KERB LINE
- PROPOSED FOOTWAY/CYCLEWAY
- PROPOSED ROAD MARKINGS
- PROPOSED OVERRUNNING AREA

GENERAL NOTES:

P03	Location updated	04/11/19	DD
P02	Roundabout updated	08/01/19	DD
Rev:	Description:	Date:	By:



Merchant Exchange, 17-19 Whitworth Street West, Manchester, M1 5WG
 0161 236 2394
 manchester@curtins.com
 www.curtins.com

Civils & Structures • Transport Planning • Environmental • Infrastructure • Geotechnical • Conservation & Heritage • Principal Designer
 Birmingham • Bristol • Cambridge • Cardiff • Douglas • Dublin • Edinburgh • Glasgow • Kendal • Leeds • Liverpool • London • Manchester • Nottingham

Project: **WARRINGTON INTERCHANGE**

Drg Title: **POTENTIAL EASTERN ACCESS ROUNDABOUT**

Project No: Originator: Zone: Level: Type: Discipline: Category / Number: Rev:

64076 - CUR - 00 - XX - DR - TP - 75001 -P03

Status: **PRELIMINARY**

Drawn By: DD Checked By: LK

Designed By: DD Date: 06/07/18

Scale: AS INDICATED

I:\mats\2\Projects\064001 - 065000\064076 - Warrington Interchange TPMAE - Drawings\2-Working\2.2-DWG\75

CLIFF LANE ROUNDABOUT ARRANGEMENT

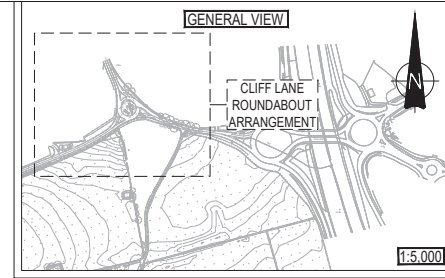
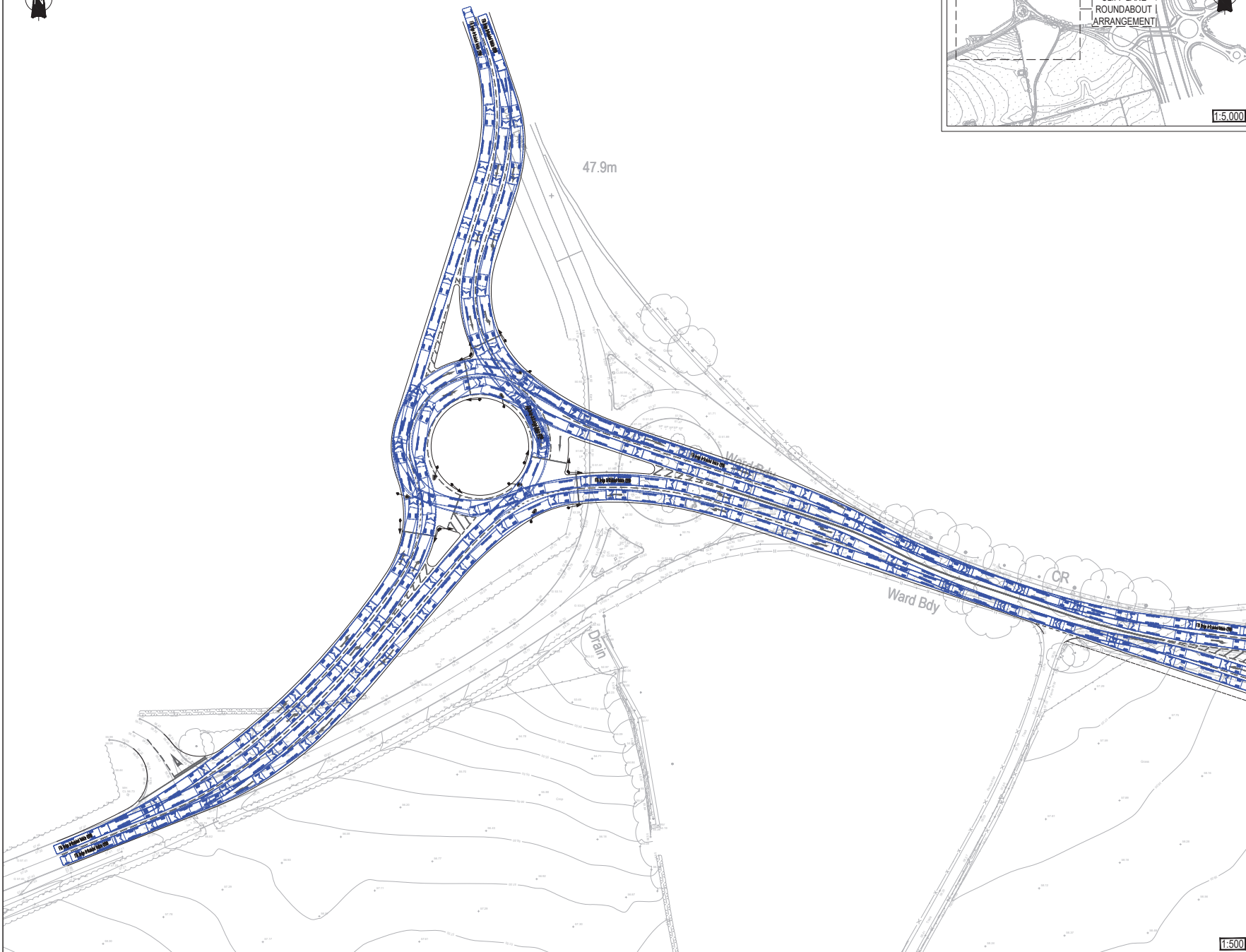

GENERAL NOTES:

- KEY: ——— PROPOSED KERB LINE
- PROPOSED FOOTWAY
- PROPOSED ROAD MARKINGS

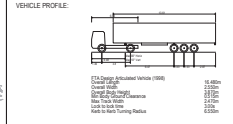

PO2	Layout updated	12/06/19	DD	FF
Rev:	Description:	Date:	By:	Check:



Manchester Exchange, 17-19 Whitworth Street West, Manchester, M1 5WG
 0161 275 2204
 manchester@curtins.com
 www.curtins.com

Cliff & Stockton - Transport Planning - Environmental - Infrastructure - Geotechnical - Construction & Heritage - Physical Design
 Birmingham Street - Congleton - Crewe - Chester - Darlington - Doncaster - Glasgow - Harrogate - Leeds - Liverpool - London - Manchester - Nottingham

Status: **PRELIMINARY**

Project: **WARRINGTON INTERCHANGE**

Dwg Title: **CLIFF LANE ROUNDABOUT
 PROPOSED IMPROVEMENTS
 SWEEP PATH ANALYSIS
 16.5m ARTICULATED HGV**

Size:	A1	Date:	22/10/18	Drawn By:	DD	Designed By:	DD	Checked By:	AV
-------	----	-------	----------	-----------	----	--------------	----	-------------	----

Scale:	AS STATED
Project No.:	64076
Originator:	CUR
Volume:	00
Level:	XX
Type:	DR
Rate:	TP
Category/Number:	05002
Rev:	PO2

1:5,000

manchester@curtins.com | 0161 275 2204 | Warrington Interchange Phase 2, 05/18

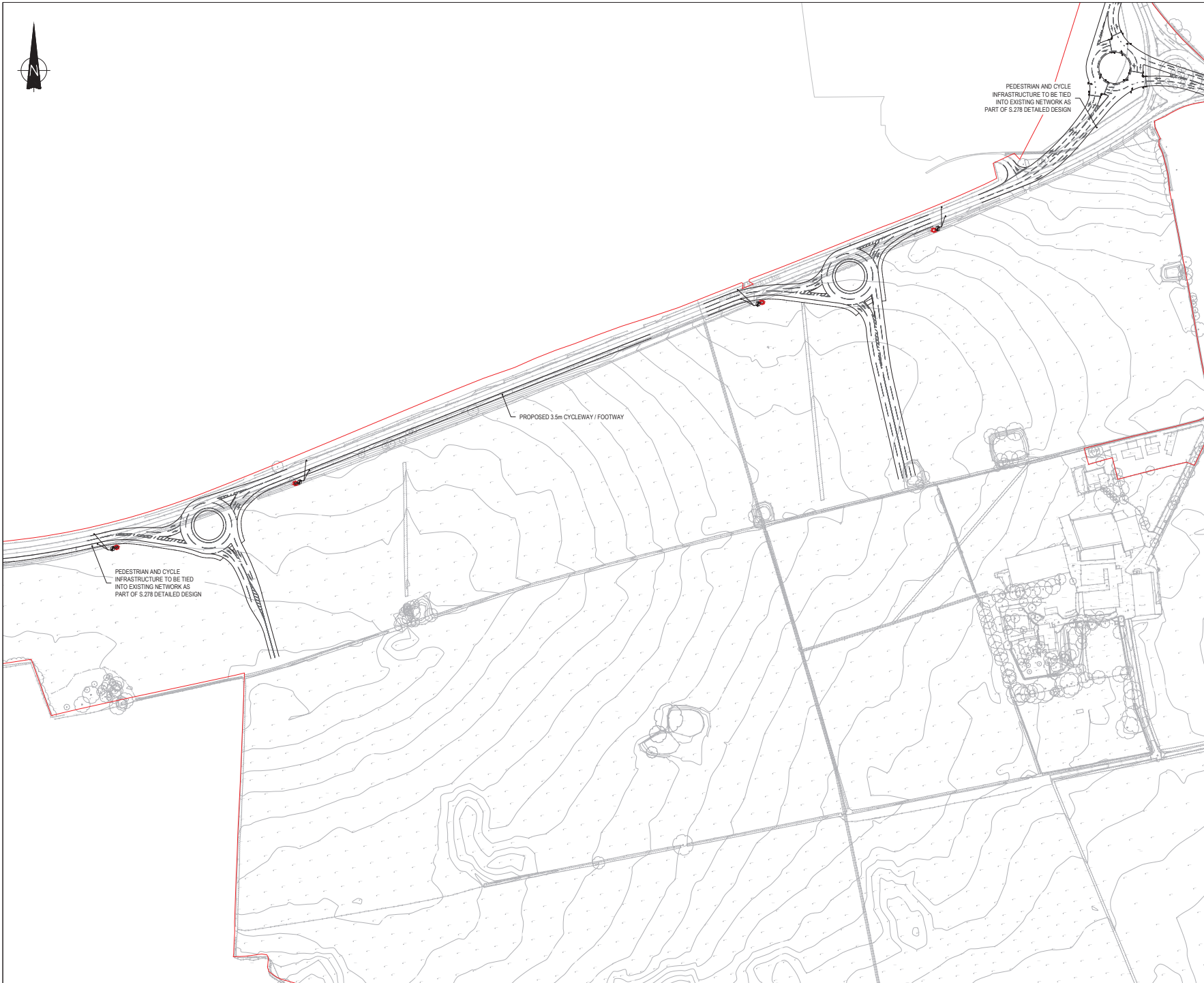

GENERAL NOTES:

- KEY: — INDICATIVE RED LINE
- PROPOSED KERB LINE
- - - - - PROPOSED 3.5m CYCLEWAY / FOOTWAY
- PROPOSED ROAD MARKINGS

PEDESTRIAN AND CYCLE INFRASTRUCTURE TO BE TIED INTO EXISTING NETWORK AS PART OF S.278 DETAILED DESIGN

PROPOSED 3.5m CYCLEWAY / FOOTWAY

PEDESTRIAN AND CYCLE INFRASTRUCTURE TO BE TIED INTO EXISTING NETWORK AS PART OF S.278 DETAILED DESIGN

PO2	Location of eastern roundabout updated	03/02/20	LL	AV
-----	--	----------	----	----

Rev	Description	Date	By	Check
-----	-------------	------	----	-------



Manchester Exchange, 17-19 Whitworth Street West, Manchester, M1 5WG
 0161 275 2204
 manchester@curtins.com
 www.curtins.com

Civil & Structural - Transport Planning - Environmental - Infrastructure - Geotechnical - Construction & Heritage - Process Design - Birmingham - Bristol - Cardiff - Chester - Dublin - Edinburgh - Glasgow - Harlow - Leeds - Liverpool - London - Manchester - Nottingham

Status: **PRELIMINARY**

Project: **WARRINGTON SIX 56**

Dwg Title: **PEDESTRIAN AND CYCLE IMPROVEMENTS**

Size	Date	Drawn By	Designed By	Checked By
A1	08/01/19	DD	DD	AV

Scale	Project No.	Operator	Volume	Level	Type	Rate	Category/Number	Rev
1:1,500	64076	CUR	00	XX	DR	TP	75014	PO2

manchester@curtins.com | 0800 0000000 | Warrington Exchange House, Exchange Way, Warrington, Cheshire, WA1 1LW